

F-Theta f=330mm

Drawing No. SH79-1064-220-330-20

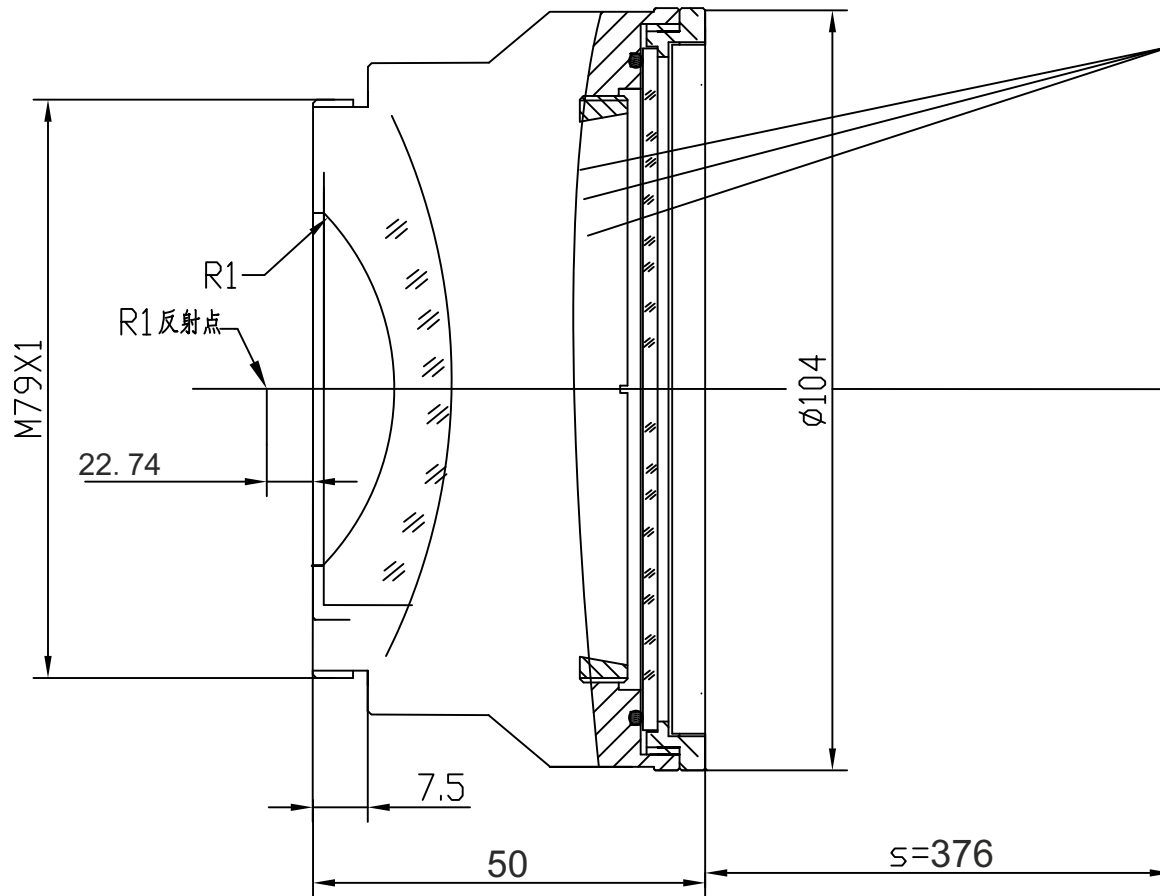

Specification

EFL	330mm
S	376mm
Wavelength	$\lambda = 1064\text{nm}$
scan angle	$\pm 28^\circ$
max scan field	220mm x 220mm
Entrance beam diameter \varnothing	20mm
Center point diameter ($1/e^2$)	33 μm
Edge point diameter ($1/e^2$)	35 μm
mirror distance m1	18
mirror distance m2	16
Transmission >	97%
Thread	M79x1
With protective window	yes